

About **US**

We offer freedom and safety in an affordable housing community for seniors and those with a qualifying mobility disability.

Lutheran Manor Apartments are owned and operated by Lutheran Manor of the Lehigh Valley, Inc. a non-profit organization. We strive to maintain safe, affordable and comfortable housing for seniors and persons with a qualifying mobility disability. Our goal is for our residents to sustain a healthy quality of life, enabling them to remain in their apartments for as long as possible. We want to be your home for many years to come.

There's always something happening at Lutheran Manor.

Lutheran Manor is conveniently located within walking distance to local shopping, banks, restaurants, medical offices and Lehigh Valley Muhlenberg Hospital, with public transportation available right at the front of our building on Westgate Drive.

Residents enjoy a variety of recreational, educational, religious and entertainment opportunities from exercise and wellness classes to crafts, in-house movies, and group outings.

Ours is a tradition of excellence and our friendly and qualified staff is focused on providing exceptional services to enhance the quality of life for senior adults or those with a qualifying mobility disability.

Our goal is to help each individual become a part of the family at Lutheran Manor.



Lutheran Manor is a vibrant senior living community offering the perfect blend of outstanding amenities and convenient and affordable living.

We've taken every detail into account to provide the perfect setting which is truly built for life.

Lutheran Manor is a 196 apartment complex owned and operated with the assistance of the Department of Housing and Urban Development, by Lutheran Manor of the Lehigh Valley, Inc., under the sponsorship of area Lutheran Churches. The corporation was established in 1971. Construction of the project funded under Section 231 of the National Housing Act was completed in 1978. Affordable, senior housing is available to qualified applicants through a Housing Assistance commitment authorized under Section 8 of the United States Housing Act.

Under the guidelines of the United States Department of Housing and Urban Development, Lutheran Manor was developed for persons 62 years of age or older with a specific number of apartments designed for persons with mobility impairments.

Contact Lutheran Manor to learn more or to schedule a tour of our beautiful community.

Call us at 610-866-6010

between 9am and 4pm, Monday through Friday

Visit our website

www.lutheranmanor.com

to print out our Application Packet



LUTHERAN MANOR
OF THE LEHIGH VALLEY, INC.



2085 Westgate Drive • Bethlehem, PA 18017
Ph: 610-866-6010 • Fax: 610-866-9773

Welcome **HOME**



LUTHERAN MANOR
OF THE LEHIGH VALLEY, INC.



Our ACCOMMODATIONS

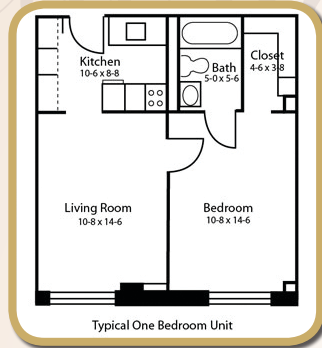
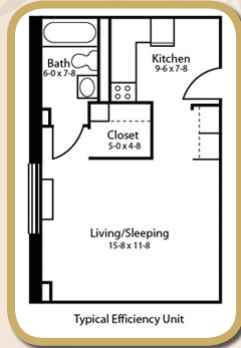

YOUR APARTMENT comes with fresh paint and new carpeting throughout. Each senior friendly kitchen boasts an electric stove, frost-free refrigerator, garbage disposal, abundant cabinet space and a large pantry area. Ample closet space is located in the bedroom. Large windows provide a beautiful view of the Lehigh Valley. Each bathroom is equipped with grab bars for easy access to the bathtub with step-in tub doors and vanity storage area. There are select apartments available for those with mobility impairments.

YOUR SECURITY is of the utmost importance. Lutheran Manor is a secure building with a telephone entry system so you can allow guests access to the building without leaving your apartment. Your monthly rent includes:

- Maintenance of building and grounds, including common areas
- Maintenance of the building plumbing, heating, air conditioning and building-owned appliances
- Electricity, individually controlled heat and air conditioning
- Water and sewer services
- Trash removal
- Refrigerator and electric range
- Signature cable service
- Wi Fi
- Wellness Center amenities
- 24 hour answering service for maintenance emergencies



Our FACILITIES

THE RESIDENTS of Lutheran Manor have access to numerous facilities within the building as well as outside complex. Inside the building there are:

- Two elevators located in our lobby
- A library and computer room
- A trash room on each floor
- A large public lounge with a small kitchen for social functions
- 2 First floor laundry rooms
- Hair Salon and Spa
- Fitness Center
- Sitting areas on each floor
- Centrally located mailbox facility
- Clean, affordable, 24 hour coin-operated laundry facilities
- Hard-wired smoke detectors and sprinklers in each apartment



OUTSIDE THE BUILDING ARE:

- Benches and sitting areas
- Flower gardens
- Pavillion
- Several garden plots for individual resident gardening
- Public bus transportation shelter in front of building
- Screened gazebo
- Greenhouse
- Private parking



Our ACTIVITIES

LUTHERAN MANOR residents can enjoy their retirement years with a variety of activities and educational programs provided to maximize the quality of life and independence of the individual. Each month residents receive a newsletter detailing the activities for the month. In addition, our own 26 passenger van provides transportation to various cultural and community events, shopping and dining experiences and entertaining shows and tours throughout the Lehigh Valley. Some of the activities include:

- Active Resident Association
- A monthly newsletter is sent to every resident
- Special yearly anniversary program
- Yearly Easter Dawn sunrise worship service
- Weekly worship services led by ordained ministers of different religious denominations
- Weekly bible study group
- Community birthday parties
- Card games and bingo
- Scheduled entertainment
- Planned group bus trips
- Various resident picnics and parties on major holidays
- Various community and educational speakers
- Occasional medical screening
- Shuffleboard and billiards
- Two annual Bazaars
- Weekly scheduled exercise classes
- Fully equipped computer lab including instructional classes
- Rent rebate and income tax preparation
- Movie showings
- Weekly exercise and yoga classes
- Life Biography class

